

Lenus

Aggiunta per il manuale d'uso
Ergänzung zur Bedienungsanleitung
Addision to the user's guide



HDTV42STC13

HDTV LCD Multituner

Digitale SAT + Digitale Terrestre + Digitale via Cavo + Analogico Terrestre
Digital SAT + Digital Terrestrisch + Digital Kabel + Analog Terrestrisch
Digital SAT + Digital Terrestrial + Digital Cable + Analogue Terrestrial

Caratteristiche LCD 42"

- Multituner HDTV (Alta Definizione) per la ricezione del Digitale Terrestre (DVB-T) + Digitale Satellite (DVB-S2) + Digitale via Cavo (DVB-C) + Analogico Terrestre
- Unica lista canali per i programmi digitali e analogici, indipendentemente dalla modalità della ricezione
- HDTV (High Definition) & SDTV (Standard Definition)
- Full HD, risoluzione 1920x1080 pixel, 100 Hz
- 3 prese HDMI
- Supporta 480i, 480p, 576i, 576p, 720i, 720p, 1080i e 1080p
- 2 CI+ Slot Common Interface
- Compatibile con modulo HD+
- Funzioni Hotel avanzate
- Funzione PVR via USB (HDD non incluso)
- Media Player (slide show, foto digitali, MP3...)
- Funzione Time Shift (visione differita)
- Software download & copia lista canali mediante connessione USB
- Volume cuffie regolabile autonomo
- Dimensioni (LxAxP): 1026x760x257 mm (con piedistallo), 1026x728x102 mm (senza piedistallo); peso: 27 kg

Pannello anteriore e laterale 42"

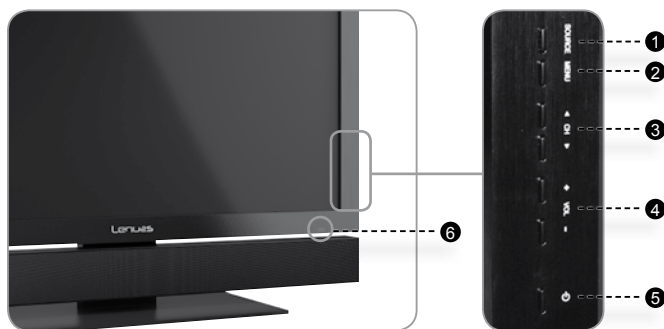

- 1 Tasto SOURCE per la scelta della sorgente d'ingresso
- 2 Tasto MENU
- 3 ◀ CH ▶ Tasti per la selezione di canali
- 4 + VOL - Tasti per la regolazione del volume, conferma della sorgente d'ingresso selezionata (V+)
- 5 ⏻ Tasto Standby
- 6 Sensore del telecomando, indicatore Standby

Pannello posteriore 42"

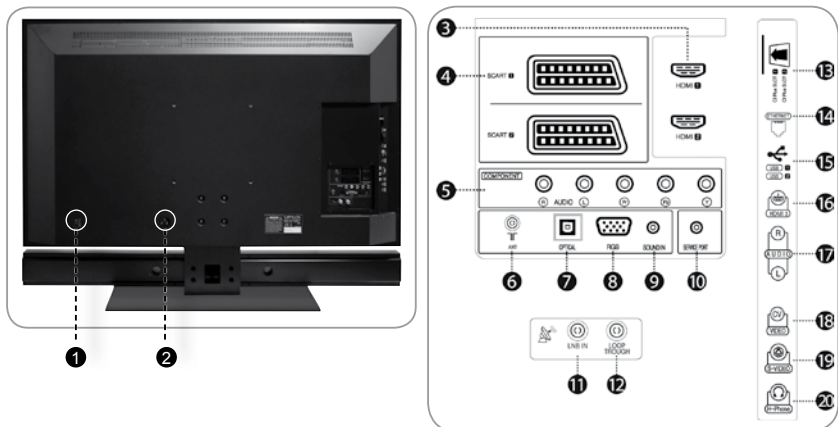

- ❶ ❶ Interruttore rete
- ❷ AC IN – Presa per il cavo di alimentazione
- ❸ HDMI 1/2 – Ingressi HDMI
- ❹ SCART 1/2 – Ingressi e uscite SCART
- ❺ COMPONENT – Ingresso Component (video e audio)
- ❻ T – Presa RF per il cavo dell'antenna terrestre
- ❼ OPTICAL – Uscita audio digitale
- ❽ RGB – Ingresso video (PC)
- ❾ SOUND IN – Ingresso audio (PC)
- ❿ SERVICE PORT – Porta di servizio
- ⓫ LNB IN – Presa per il cavo dell'antenna satellitare
- ⓬ LOOP THROUGH – Uscita per la connessione di un ulteriore ricevitore
- ⓭ 2 x CI+ SLOT – Slot per due moduli CI+
- ⓮ ETHERNET – Ingresso cavo LAN
- ⓯ 2 x USB – Prese USB
- ⓰ HDMI 3 – Ingresso HDMI
- ⓱ AUDIO – Ingressi audio
- ⓲ VIDEO – Ingresso video
- ⓳ S-VIDEO – Ingresso S-Video
- ⓴ H-PHONE – Presa per il collegamento delle cuffie

D

Technische Daten LCD 42"

- Multituner HDTV (High Definition) für den Digitalen Terrestrischen (DVB-T) + Digitalen Satelliten (DVB-S2) + Digitalen Kabel (DVB-C) + Analogen Terrestrischen Empfang
- Gemeinsame Kanalliste für Analog und Digital ohne Empfangsebenenumschaltung
- HDTV (High Definition) & SDTV (Standard Definition)
- Full HD, Auflösung 1920x1080 Pixel, 100 Hz
- 3 HDMI Anschlüsse
- Unterstützt 480i, 480p, 576i, 576p, 720i, 720p, 1080i und 1080p (je nach Eingang)
- 2 CI+ Common Interface Slots
- Kompatibel zu HD+
- Erweiterte Hotelfunktionen
- PVR-Funktion über USB (HDD nicht im Lieferumfang inbegriffen)
- Media Player (Diashow, digitale Foto, MP3...)
- Time Shift Funktion (zeitversetztes Fernsehen)
- Kopieren der Kanalliste und Software Download mittels USB
- Kopfhörerlautstärke autonom steuerbar
- Dimensionen (LxHxB): 1026x760x257 mm (mit Standfuß), 1026x728x102 mm (ohne Standfuß); Gewicht: 27 kg

Vorderseite und Seitenansicht 42"

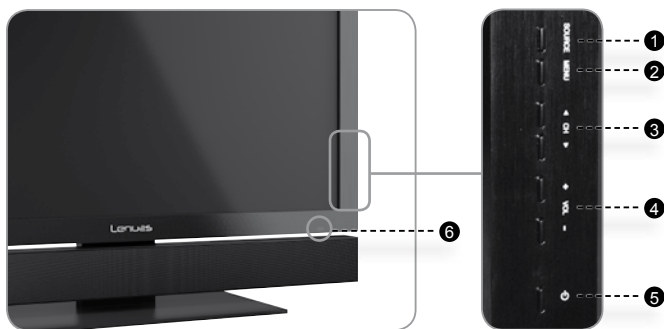

- 1 SOURCE Taste (Wahl der Eingangsquelle)
- 2 MENU Taste
- 3 ◀ CH ▶ Tasten für Senderauswahl
- 4 + VOL - Lautstärkeregelung, Bestätigung der Eingangsquelle (V+)
- 5 ⏻ Standby-Taste
- 6 Sensor der Fernbedienung, Standby-/Betriebsanzeige

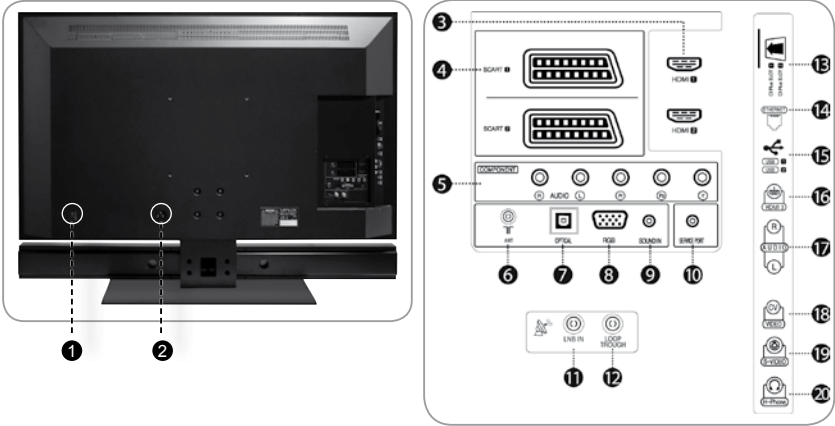

- ① Netzschalter
- ② AC IN – Anschluss für das Netzkabel
- ③ HDMI 1/2 – HDMI-Eingänge
- ④ SCART 1/2 – SCART Ein- und Ausgänge
- ⑤ COMPONENT – Component-Eingang (Video und Audio)
- ⑥ T- RF Antennenanschluss
- ⑦ OPTICAL – Digitaler Audioausgang
- ⑧ RGB – Videoeingang (PC)
- ⑨ SOUND IN – Audioeingang (PC)
- ⑩ SERVICE PORT – Service-Anschluss
- ⑪ LNB IN – Anschluss für das Satellitenantennenkabel
- ⑫ LOOP THROUGH – Anschluss für einen zusätzlichen SAT-Receiver
- ⑬ 2 x CI+ SLOT – Steckplatz für zwei CI+ Module
- ⑭ ETHNET – Anschluss für den LAN Kabel
- ⑮ 2 x USB – Anschlüsse
- ⑯ HDMI 3 – HDMI-Eingang
- ⑰ AUDIO – Eingänge
- ⑱ VIDEO – Eingang
- ⑲ S-VIDEO – Eingang
- ⑳ H-PHONE – Kopfhöreranschluss

Specifications LCD 42 inch

- Multituner HDTV (High Definition) for Digital Terrestrial (DVB-T) + Digital Satellite (DVB-S2) + Digital Cable (DVB-C) + Analogue Terrestrial Reception
- Common channel list for analogue & digital, no switching between the sources
- HDTV (High Definition) & SDTV (Standard Definition)
- Full HD, resolution 1920x1080 pixel, 100 Hz
- 3 HDMI ports
- Supports 480i, 480p, 576i, 576p, 720i, 720p, 1080i and 1080p
- 2 CI+ Common Interface slots
- HD+ compatible
- Advanced Hotel TV menu
- PVR Function through USB (HDD not included)
- Media Player (slide show, digital photo, MP3...)
- Time Shift Function
- Program list copy and software download through USB
- Headphone Volume independently controllable
- Dimensions (WxHxD): 1026x760x257 mm (with stand),
1026x728x102 mm (without stand); weight: 27 kg

Front and Side Panel LCD 42 inch

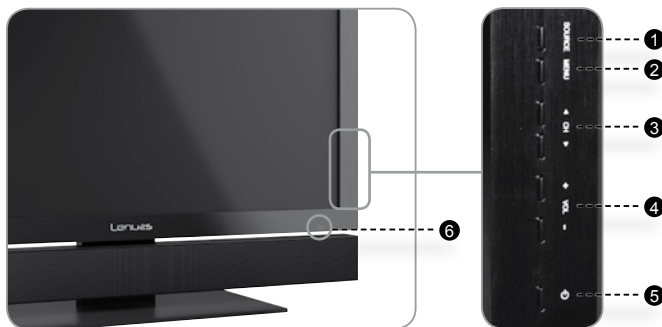

- 1 SOURCE selection
- 2 MENU selection
- 3 ◀ CH ▶ Channel selection
- 4 + VOL - Volume adjustment and source selection confirmation (VOL+)
- 5 ⏻ Standby on/off button
- 6 Remote control sensor and standby/on indication

Rear Panel LCD 42 inch

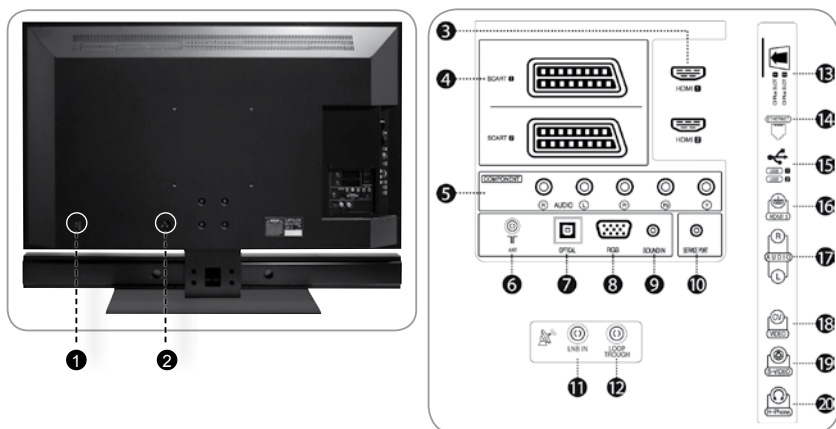

- ① ① Power button
- ② ② AC IN – AC Power Input
- ③ ③ HDMI 1/2 –HDMI Input
- ④ ④ SCART 1/2 – Inputs and Outputs
- ⑤ ⑤ COMPONENT – Component Input (video and audio)
- ⑥ ⑥ TΓ – RF connector to the terrestrial antenna
- ⑦ ⑦ OPTICAL – Digital Audio Output
- ⑧ ⑧ RGB – Video Input (PC)
- ⑨ ⑨ SOUND IN – Audio Input (PC)
- ⑩ ⑩ SERVICE PORT – Connector for service
- ⑪ ⑪ LNB IN – Input for the satellite antenna cable
- ⑫ ⑫ LOOP THROUGH - Loop output to connect a second satellite receiver
- ⑬ ⑬ 2 x CI+ SLOT – Slots for CI+ Modules
- ⑭ ⑭ ETHERNET – Connection for the LAN cable
- ⑮ ⑮ 2 x USB – USB ports
- ⑯ ⑯ HDMI 3 – HDMI Input
- ⑰ ⑰ AUDIO – External Audio Input
- ⑱ ⑱ VIDEO – External Video Input
- ⑲ ⑲ S-VIDEO – S-Video Input
- ⑳ ⑳ H-PHONE – Headphone connector

I

Pagina manuale 46:

Nel **Menu Controllo HDD** si può scegliere la memoria esterna che viene usata per le registrazioni in caso di due memorie esterne collegate contemporaneamente.

D

Manual Seite 46:

Im **Festplattensteuerungsmenü** können Sie bei zwei angeschlossenen USB-Speichermedien einstellen, welches Medium für die Aufnahmen verwendet wird.

GB

Manual page 45:

In the **HDD control menu** you can select the external storage which is used for registration if there are connected two storages.

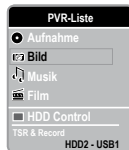
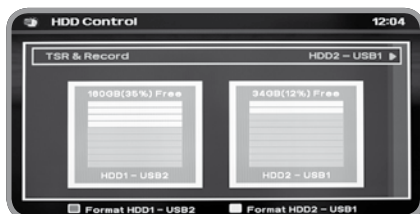

I

Pagina manuale 49:

La funzione **PIP - Picture in Picture** è possibile solo tra fonti digitali ed analogiche.



D

Manual Seite 50:

Die **PIP - Bild in Bild** Funktion ist nur zwischen digitalen und analogen Quellen möglich.



GB

Manual page 48:

The **PIP - Picture in Picture** function is available only between digital and analogue sources.

